

NOTES
 2. MODIFIED DRAWING APPROVED BY COMM. (PLG) VIDE ORDERS DATED 20.8.98. VIDE FILE NO. F4(15)94/DWK/DDA. AT PAGE NO. 17/N.

दि. वि. प्रा. द्वारका उपशहर परियोजना

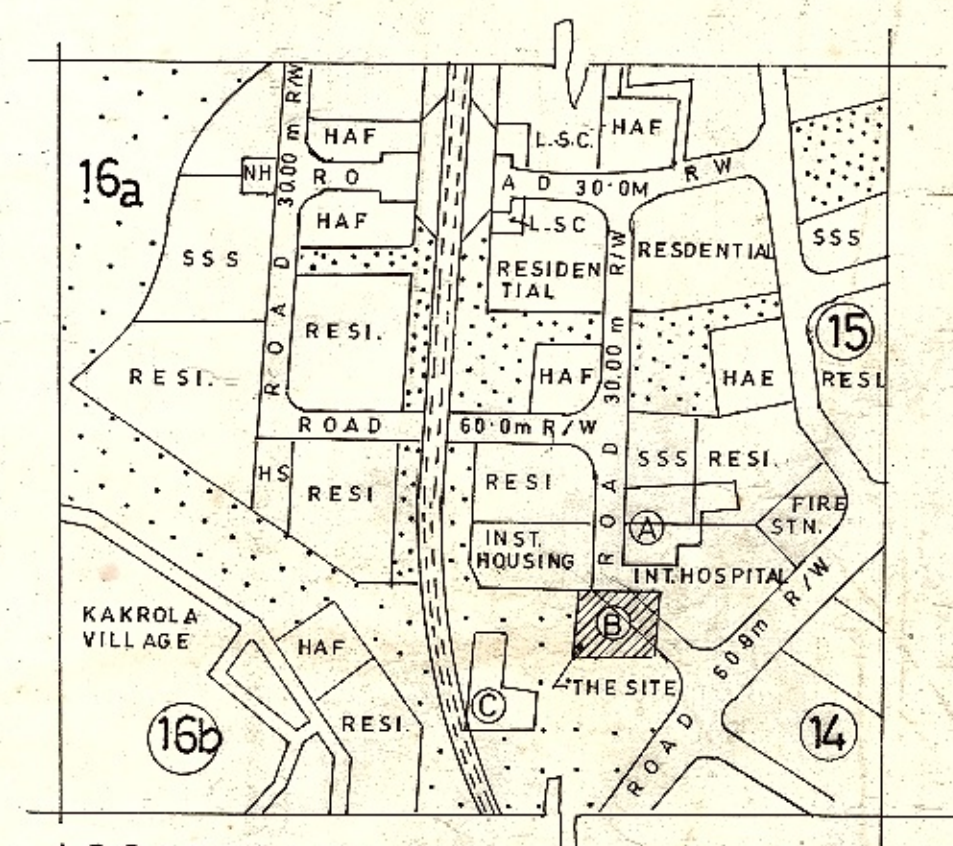
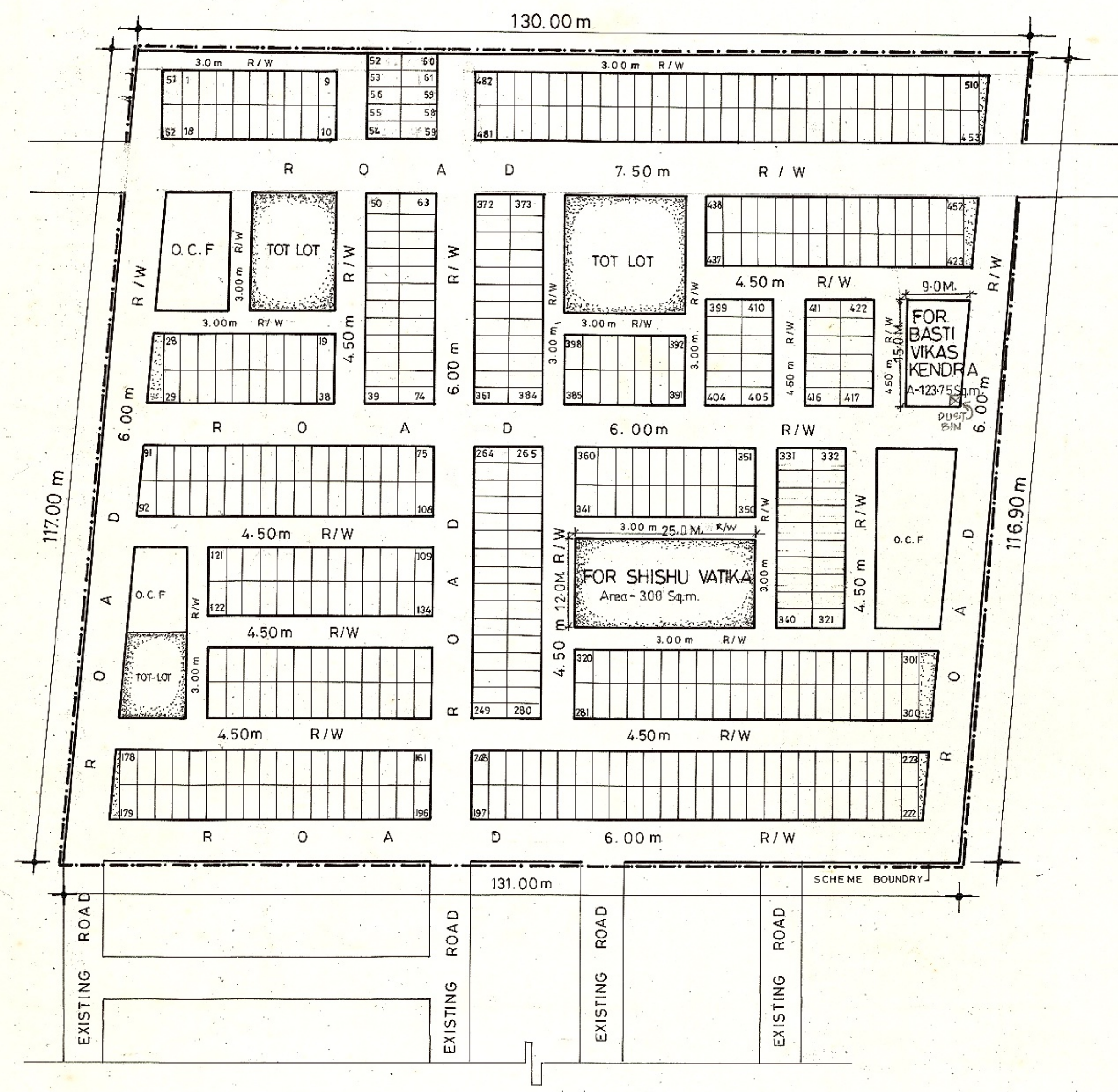

NOTE :-
 INCORPORATED BASTI VIKAS KENDRA & SHISHU VATIKA SITE ON OCF/TOT LOT PLOT APPROVED BY COMM.(PLG) IN FILE NO. F13(15)/2001/PLG/DWK DT. 9-1-2002 ON PAGE NO. 4/N & DRAFT PLAN NO. 22/C.

AREA STATEMENT

TOTAL AREA OF THE POCKET	15200 sq.m.	
USES	AREA (in sqm)	% age
RESIDENTIAL	6375.00	41.94
O.C.F	672.50	4.42
GREEN	939.50	6.18
CIRCULATION	7213.00	47.46

MODIFIED DRAWIN

No. OF PLOTS 510
 SIZE OF PLOT 2.50m X 5.00m = 12.50 sqm

NOTE
 1. THE DRAWING IS PREPARED BASED ON THE PT SURVEY SUPPLIED BY JD(S) DWARKA.

LAYOUT PLAN OF TRANSIT CAMP (REVISED)

DWARAKA SUB-CITY (PAIPANKAJA)

VACANT POCKET 'B' (SECTOR 15)		002/TC/PKT B/SEC 15/ DRG No. DWK 98/R1
		1:500 SCALE
PLG D/MAN	(S.P. KAUR) PLG. ASSTT.	(M.L. CHHABRA) ASSTT. DIRECTOR
sd/- (AK. MANNA) DY. DIRECTOR	sd/- (A.K. GUPTA) DIRECTOR	sd/- 19.8. N.K. AGGARWAL O.S.D.(PLG) COORDN (VIJAY RISHBUD) COMMISSIONER (PLG)
दिल्ली विकास प्राधिकरण		